

LEGEND

- Travel Way of Proposed Roadway
- Shoulder of Proposed Roadway
- Proposed Raised Traffic Islands
- Proposed Sidewalk
- Access Points to Proposed Roadway (Drives, etc.)
- Approximate Limit of Slope Work and Landscaping
- Removal of Existing Pavement Outside of Slope Work
- Existing Pavement (Roadways, Drives, Sidewalks, etc.)
- Existing Gravel Surface (Drives, Paths, etc.)
- Existing Tree and/or Brush Line
- Water (Rivers, Streams, Lakes, Ponds, Swamps, etc.)
- Buildings
- Buildings To Be Removed
- Bridge Removal
- Wetlands
- Property Lines
- State, County, City and Town Lines
- Existing Easement Lines
- Proposed Easement Lines
- Existing R.O.W. (Right-of-Way)
- Proposed R.O.W.
- Existing C.A.R.O.W. (Controlled Access)
- Proposed C.A.R.O.W.
- Existing L.A.R.O.W. (Limited Access)
- Proposed L.A.R.O.W.

Prepared By
New Hampshire Department of Transportation
Highway Design Bureau

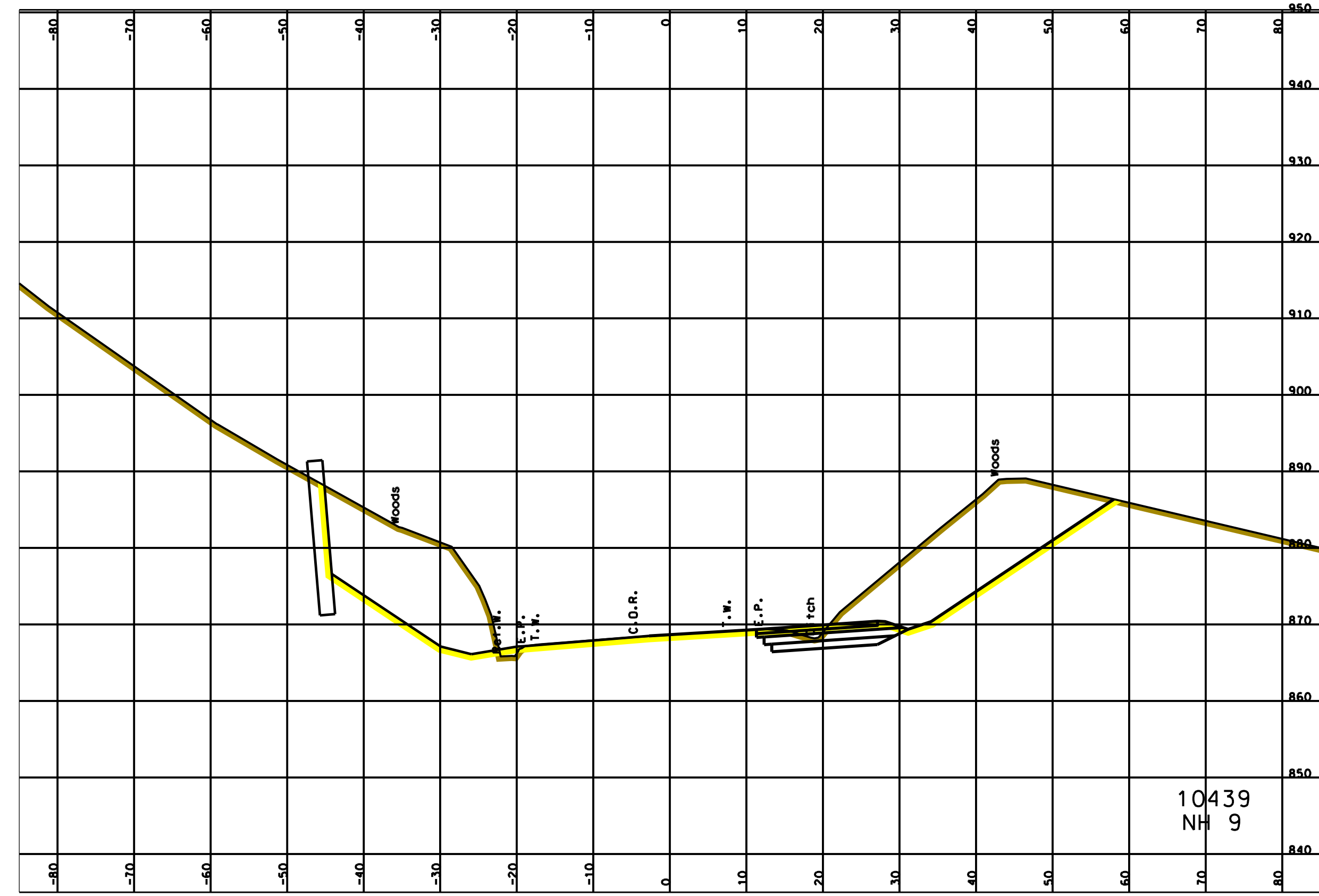

ALTERNATIVE B

\$ 1,720,000

ROXBURY SULLIVAN 10439
F-X-012-1(34)
REPLACE RETAINING WALL

40 0 40 80
SCALE IN FEET