

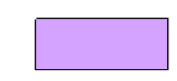

###  
###  
###  
JAQUES,  
MARY MARGARET  
& ROGER

**LEGEND**

-  PROPOSED PAVEMENT
-  PROPOSED SIDEWALK
-  EXISTING PAVEMENT
-  LIMIT OF SLOPE WORK

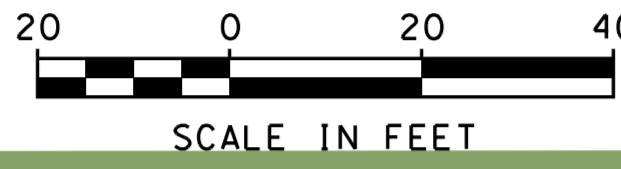

# DURHAM 16254 NH 108-US 4 WESTBOUND RAMP INTERSECTION IMPROVEMENTS

###  
###  
STATE  
OF NH

STA. 116+00  
BEGIN CONSTRUCTION

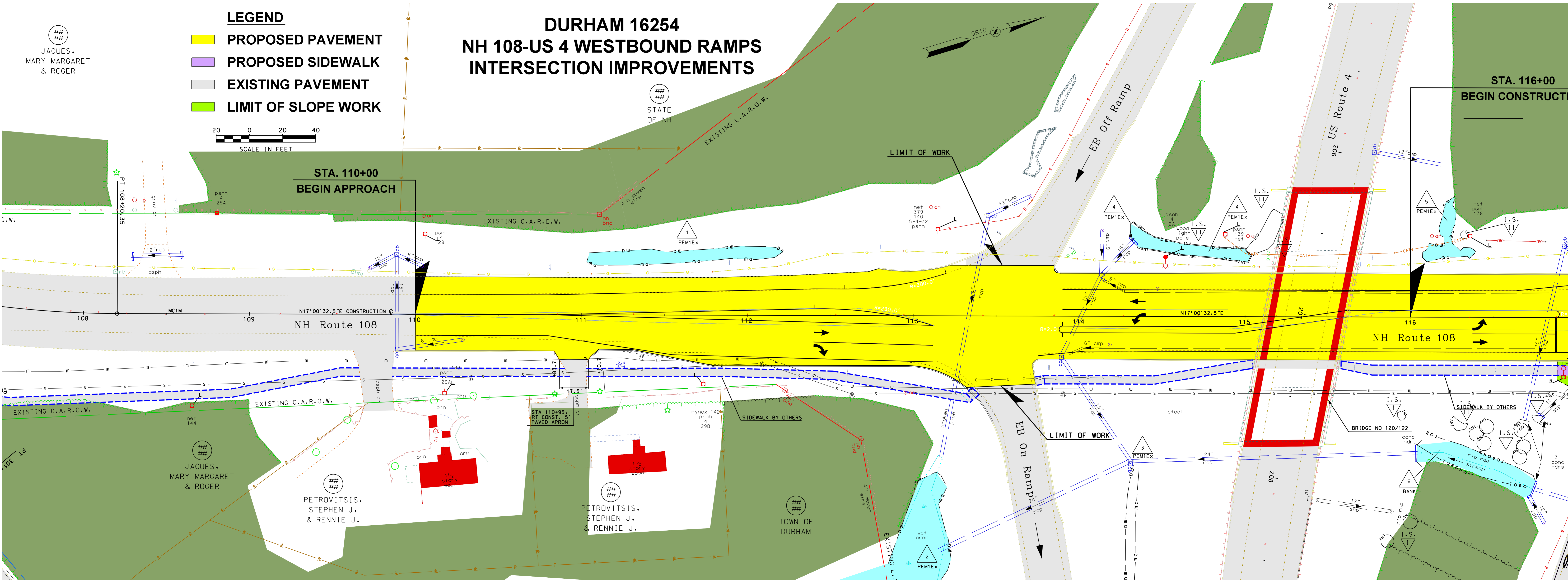

###  
###  
###  
JAQUES,  
MARY MARGARET  
& ROGER

###  
###  
###  
PETROVITSIS,  
STEPHEN J.  
& RENNIE J.

###  
###  
###  
PETROVITSIS,  
STEPHEN J.  
& RENNIE J.

###  
###  
###  
TOWN OF  
DURHAM



# DURHAM 16254 NH 108-US 4 WESTBOUND RAMPS INTERSECTION IMPROVEMENTS

- LEGEND**
- PROPOSED PAVEMENT
  - PROPOSED SIDEWALK
  - EXISTING PAVEMENT
  - LIMIT OF SLOPE WORK



NH ROUTE 108 CURVE# 1  
 PI= STA. 119+77.73  
 N = 234026.48  
 E = 1186035.35  
 Δ = 12°53'59.84" RT  
 T = 226.10'  
 R = 2000.00'  
 L = 450.29'  
 E = 12.74'

NH ROUTE 108 CURVE# 2  
 PI= STA. 125+50.22  
 N = 234524.38  
 E = 1186321.76  
 Δ = 4°01'04.26" LT  
 T = 175.38'  
 R = 5000.00'  
 L = 350.62'  
 E = 3.07'





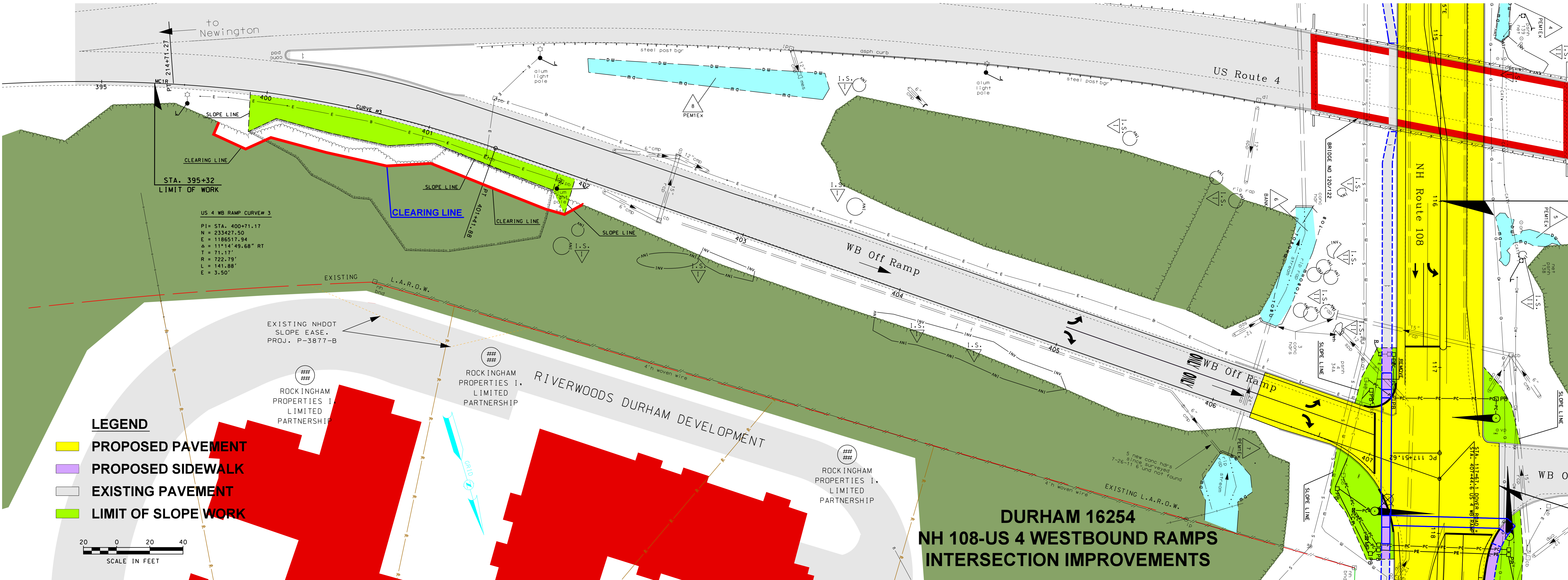

STA. 395+32  
 LIMIT OF WORK  
  
 US 4 WB RAMP CURVE # 3  
 P1 = STA. 400+71.17  
 N = 233427.50  
 E = 1186517.94  
 $\Delta = 111^{\circ}14'49.68''$  RT  
 T = 71.17'  
 R = 722.79'  
 L = 141.88'  
 E = 3.50'

EXISTING NHDOT  
 SLOPE EASE.  
 PROJ. P-3877-B

###  
 ###  
 ROCKINGHAM  
 PROPERTIES I,  
 LIMITED  
 PARTNERSHIP

###  
 ###  
 ROCKINGHAM  
 PROPERTIES I,  
 LIMITED  
 PARTNERSHIP

###  
 ###  
 ROCKINGHAM  
 PROPERTIES I,  
 LIMITED  
 PARTNERSHIP

**LEGEND**

- PROPOSED PAVEMENT
- PROPOSED SIDEWALK
- EXISTING PAVEMENT
- LIMIT OF SLOPE WORK



**DURHAM 16254  
NH 108-US 4 WESTBOUND RAMPS  
INTERSECTION IMPROVEMENTS**