

REVISION DATE
07-13-2001
02-26-2010
02-22-2021

\*.DGN FILE NAME

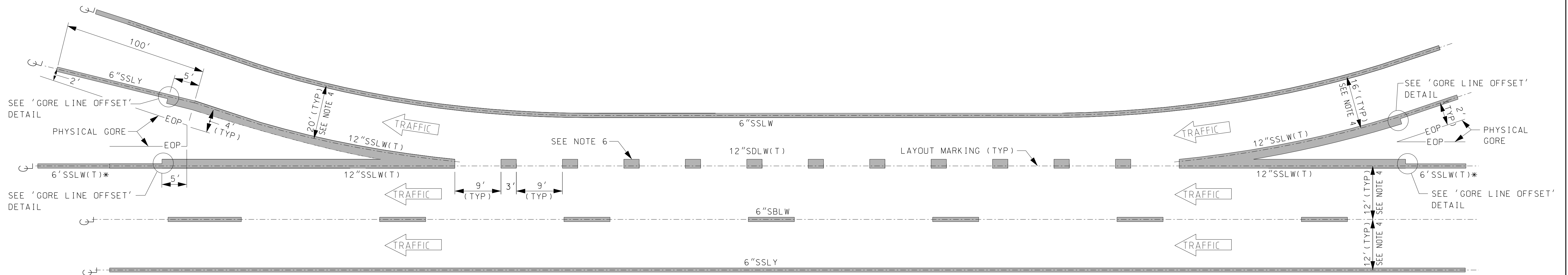

**ENTRANCE AND EXIT RAMP WEAVING SECTION MARKINGS**

NOT TO SCALE - REFERENCE: MUTCD FIGURE 3B-10(E)

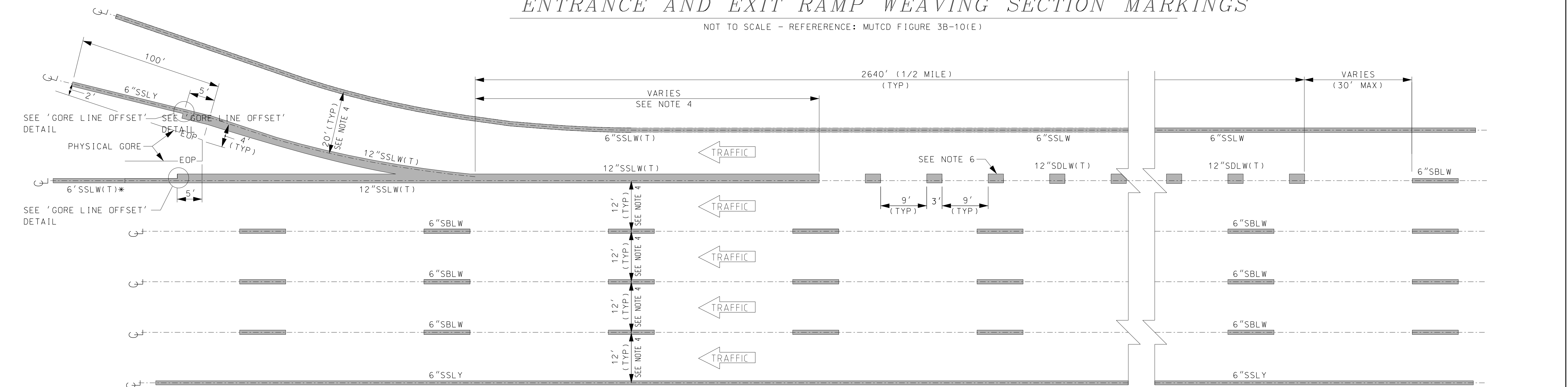

**EXIT RAMPS WITH LANE DROP AT EXIT**

NOT TO SCALE - REFERENCE: MUTCD FIGURE 3B-10(A)

**LEGEND**

(T) THERMOPLASTIC  
 6"SSLW(T)\* IF ASSOCIATED WITH A PARTIAL INTERCHANGE, MAY BE PAINT.

TRAFFIC ARROWS SHOWN ON THIS SHEET INDICATE DIRECTION OF TRAFFIC ONLY.

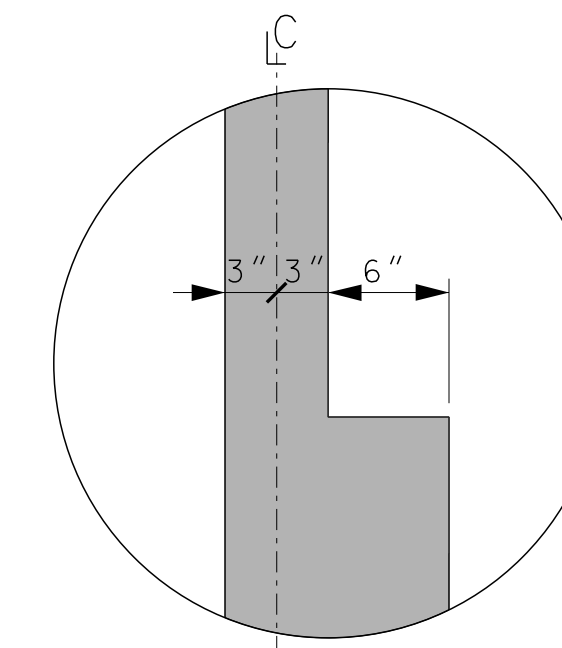

GORE LINE OFFSET (SIMILAR FOR ALL) N.T.S.

**PAVEMENT MARKING STANDARD**

DIVIDED HIGHWAY WEAVE/LANE DROP RAMP MARKINGS

**GENERAL NOTES**

- ALL RAMPS WITH A MINIMUM ROADWAY WIDTH OF 20' SHALL RECEIVE BOTH WHITE EDGE LINE AND YELLOW MEDIAN LINE WHETHER THE RAMP HAS RAISED CURB OR NOT.
- THE EDGE AND MEDIAN LINE MARKINGS FOR FREEWAY RAMPS WILL BE A MINIMUM OF 24" FROM CENTERLINE TO THE FACE OF CURB OR EDGE OF PAVEMENT. MEDIAN LINE MARKINGS FOR ALL OTHER RAMPS WILL BE A MINIMUM OF 30" FROM THE CURB OR EDGE OF PAVEMENT.
- THE MINIMUM DISTANCE BETWEEN THE EDGE AND MEDIAN LINES FOR RAMPS SHALL BE 14'. THE MEDIAN LINE ON A RAMP SHALL CONNECT WITH THE GORE MARKING. THE EDGELINE SHALL CONNECT WITH THE MAINLINE EDGELINE TO PROVIDE A CONTINUOUS LINE.
- SEE PAVEMENT MARKING PLANS OR OTHER PROJECT DOCUMENTS FOR PROJECT SPECIFIC DESIGN DIMENSIONS.
- ALL DOTTED LANE LINES FOR ACCELERATION/DECELERATION LANES SHALL RUN THE FULL LENGTH OF EACH LANE AS SHOWN IN THE PROJECT DOCUMENTS.
- 12"SDLW SHOULD BE INSTALLED OFFSET FROM THE CENTERLINE AS SHOWN TO MATCH INTO THE GORE.