

THE STATE OF NEW HAMPSHIRE
DEPARTMENT OF TRANSPORTATION
RIGHT-OF-WAY PLANS
FEDERAL AID PROJECT
STP-BRF-X-T-032-1(21)
N.H. PROJECT NO. P-4370
US 302

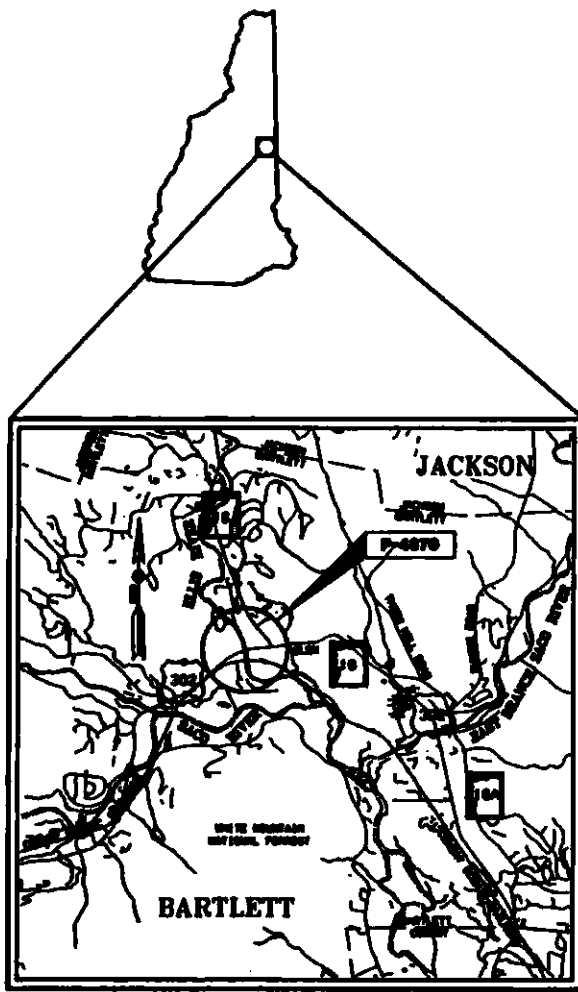

LOCATION MAP

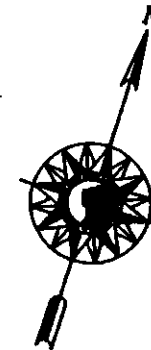

INDEX OF SHEETS

- XX FRONT SHEET
- XX STANDARD SYMBOLS SHEET
- XX SUMMARY SHEET
- XX PROPERTY LAYOUT
- XX RIGHT-OF-WAY PLANS

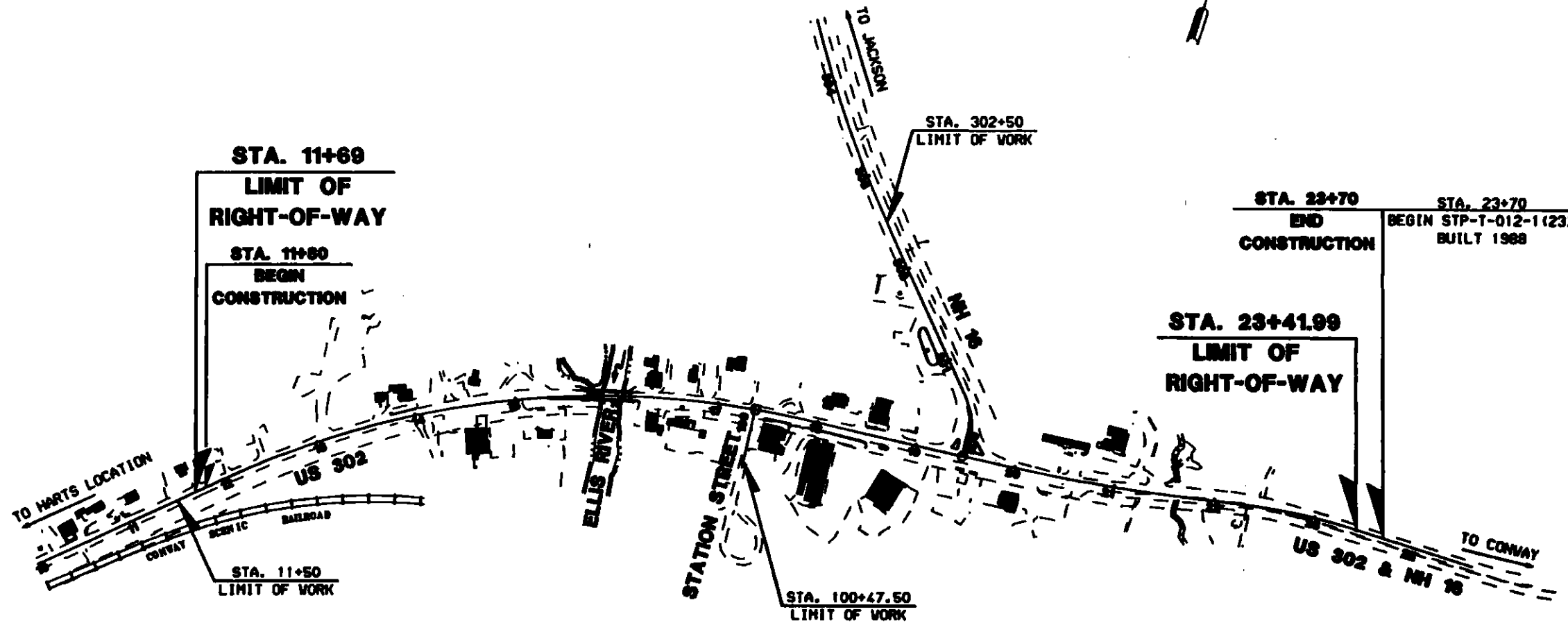

TOWN OF BARTLETT
COUNTY OF CARROLL
SCALE 1 : 2500

METRIC

NOTE: IF TOWN OR CITY FUNDING IS INVOLVED, INCLUDE OBJECT TITLE: MUN FOR ADDITIONAL SIGNATURE.

NHDOT		THE STATE OF NEW HAMPSHIRE DEPARTMENT OF TRANSPORTATION	
RECOMMENDED FOR APPROVAL:			
DIRECTOR OF PROJECT DEVELOPMENT		DATE	
ADMINISTRATOR, BUREAU OF MUNICIPAL HIGHWAYS		DATE	
APPROVED:			
ASSISTANT CHIEF ENGINEER AND CHIEF ENGINEER		DATE	
APPROVED BY BUREAU OF RIGHT-OF-WAY			
ADMINISTRATOR		DATE	

DESIGNED BY JOHN CANNON, III
CHECKED BY ALVIN BULLFIN
DATE 11/18/87
DATE 11/20/87

FOR CONSTRUCTION AND ALIGNMENT DETAILS - SEE CONSTRUCTION PLANS

FEDERAL PROJECT NO.	STATE PROJECT NO.	SHEET NO.	TOTAL SHEETS
	P-4370	1	

STATE OF NEW HAMPSHIRE

DEPARTMENT OF TRANSPORTATION • BUREAU OF HIGHWAY DESIGN

SAMPLE PLANS

DATE 31-DEC-1998

RIGHT - OF - WAY SUMMARY SHEET

TABLE OF PROPERTY ACQUISITION

PAR. NO.	SHEET NO.	PROPERTY OWNER	TOTAL AREA OF PARCEL		TAXES		REMAINDER				EASEMENT				CROSS POINTS OF ACQUIS.		REMARKS
			sq	ac	sq	ac	LEFT		RIGHT		PERMANENT		TEMPORARY		L1	R1	
							sq	ac	sq	ac	sq	sf	TYPE	sq			
1	5 & 6	MAINE CENTRAL R.R.	-	-	-	-	-	-	-	-	-	-	-	-	-	-	-
2	6	THE HOWARD TRUST	23.838	58.80	-	-	23.838	58.80	-	-	-	-	-	-	-	-	-
3	5 & 6	HONNOR, GEORGE L., LETITIA S.	0.219	0.54	-	-	0.219	0.54	-	-	-	-	-	-	-	-	-
4	6	ROYAL, RICHARD E., BARBARA S.	0.128	0.32	-	-	0.128	0.32	-	-	-	-	-	20	215	DRIVE	11/15/99
5	6	ROBERTS, LYNN S. JUDITH	0.408	1.00	-	-	0.408	1.00	-	-	-	-	-	-	-	-	-
6	6 & 7	PATOL, RONALD J.	0.445	1.10	-	-	-	-	0.445	1.10	64	804	SLOPE	-	-	-	-
7	6 & 7	STATE OF NEW HAMPSHIRE	2.428	6.00	-	-	2.428	6.00	-	-	-	-	-	-	-	-	-
8	7	ROBER, JOHN & DOROTHEA	0.255	0.63	-	-	-	-	0.255	0.63	-	-	-	88	947	DRIVE	11/15/99
9	7	BOFF, RICHARD J., JR., MURPHY WILLIAM	0.134	0.33	-	-	-	-	0.134	0.33	-	-	-	42	452	DRIVE	11/15/99
10	7	THE HOWARD TRUST	0.548	1.36	-	-	0.548	1.36	-	-	-	-	-	-	-	-	-
11	7	HORTON, CLARA L.	21.953	54.00	-	-	21.953	54.00	-	-	-	-	-	8	88	DRIVE	11/15/99
12	7 & 8	PATOL, RONALD J.	1.062	2.60	-	-	-	-	1.062	2.60	22	237	DRAINAGE CHANNEL	116	1248	-	-
														1798	19364	TRAFFIC CONTROL	11/15/99
														258	2777	DRIVE	11/15/99
13	7	CHARLES, LESTER L., ALICE H.	0.408	1.00	-	-	0.408	1.00	-	-	-	-	-	80	846	DRIVE	11/15/99
14	7 & 8	DURZA, JOE ELLEN	0.890	2.20	-	-	0.890	2.20	-	-	134	1442	DRAINAGE	-	-	-	-
														252	2713	SLOPE	-
														488	5231	CHANNEL	-
15	8	BARONETTI, JANICE E.	0.304	0.78	0.018	0.04	0.289	0.71	-	-	148	1683	CHANNEL	-	-	-	-
														52	580	SLOPE	-
														6	88	GUARDRAIL CHANNEL	-
16	8	TOWN OF BARTLETT	0.125	0.31	0.010	0.02	-	-	0.115	0.29	324	3488	CHANNEL	-	-	-	-
														848	9128	DRAINAGE	-
														90	988	SLOPE	-
														62	660	DRIVE	11/15/99
														672	7222	TRAFFIC CONTROL	11/15/99
																	THIS PARCEL IS A COMPLETE ACQUISITION
17	8 & 9	MORRIS A. FERRARO PARTNERSHIP	0.283	0.68	0.010	0.02	-	-	0.283	0.63	-	-	-	18	194	DRIVE	11/15/99
														244	2628	TRAFFIC CONTROL	11/15/99
18	9	INDUSTRIAL MILL BUILDERS, INC.	0.287	0.68	-	-	-	-	0.287	0.68	60	431	DRAINAGE	-	-	-	-
19	9	RICHMOND, DAVID J., JONNE H.	0.255	0.63	-	-	-	-	0.255	0.63	600	6490	DRAINAGE	-	-	-	-
20	9 & 10	SEAN COMMUNITY BAPTIST CHURCH	5.188	0.48	0.010	0.02	0.178	0.44	-	-	-	-	-	20	215	DRIVE	11/15/99
21	9	GRANT, MARGARET F.	0.388	0.98	0.015	0.04	0.373	0.92	-	-	-	-	-	18	172	DRIVE	11/15/99
22	9	RED PHOENIX PUB. INC.	0.221	0.57	0.010	0.02	-	-	0.221	0.56	22	237	DRAINAGE	-	-	-	-
														22	237	SLOPE	-
														138	1484	TRAFFIC CONTROL	11/15/99
23	9	RED PHOENIX PUB. INC.	0.170	0.42	19 SF	108 SF	-	-	0.170	0.42	12	128	RET WALL	-	-	-	-
														24	258	DRIVE	11/15/99
														28	301	CONSTRUCTION	11/15/99
24	9	BOONE, MARGARET	0.897	1.50	-	-	-	-	0.897	1.50	-	-	-	82	882	DRIVE	11/15/99
25	9	WYBIST, EVAN I.	0.282	0.69	22 SF	237 SF	0.282	0.69	-	-	80	861	SLOPE	-	-	-	-
														188	1701	DRIVE	11/15/99
26	9	LANSDOWN, JAMES P., SILEEN H.	0.243	0.60	0.020	0.05	0.223	0.55	-	-	6	88	DRAINAGE	-	-	-	-
27	14	THE NORTH CONWAY BRICK	1.812	2.80	0.090	0.12	0.992	2.38	-	-	-	-	-	304	3686	CONSTRUCTION	11/15/99
28	9, 10, 14	MORRISI, FRANK C., SILEEN C.	0.282	0.69	0.025	0.01	0.197	0.49	-	-	-	-	-	448	4728	DRIVE	11/15/99
														114	1227	DRIVE	11/15/99
29	10, 14	MOUNT WASHINGTON BRISTOL ROAD COMPANY	0.121	0.20	0.045	0.11	0.076	0.19	-	-	28	288	SLOPE	-	-	-	-
														40	431	SLOPE	-
30	9, 10, 14	GRANT DEVELOPMENT CORPORATION	0.928	2.28	0.010	0.02	-	-	0.918	2.27	2	22	DRAINAGE RET WALL	-	-	-	-
														212	2282	-	-
30B	10, 14	GRANT DEVELOPMENT CORPORATION	0.300	0.74	-	-	-	-	0.300	0.74	-	-	-	288	2738	DRIVE	11/15/99
31	9	NEW HAMPSHIRE ELECTRIC COOPERATIVE INC.	0.214	0.53	-	-	-	-	0.214	0.53	-	-	-	42	452	DRIVE	10/15/99
32	10	BOONE-BRUBAKER, INC.	0.372	0.92	-	-	-	-	0.372	0.92	-	-	-	-	-	-	-
33	10-13	FILIP, JIM S., TOFFT, CHARLES	24.807	61.30	0.318	0.78	-	-	24.482	60.52	-	-	-	214	2383	DRIVE	11/15/99
34	10	MOUNT WASHINGTON BRISTOL ROAD COMPANY	0.182	0.45	0.055	0.14	0.127	0.31	-	-	-	-	-	-	-	-	-
35	10, 11 & 14	STORTON MOTOR INC. INC.	1.812	2.80	0.300	0.75	0.712	1.75	-	-	148	1872	DRAINAGE	-	-	-	-
														184	1788	DRIVE	11/15/99
														80	848	CONSTRUCTION	11/15/99
36	11-13	FILIP, JIM S., TOFFT, CHARLES	21.944	52.00	0.090	0.18	20.894	51.85	-	-	682	7128	SLOPE	-	-	-	-
														28	288	SLOPE	-
														418	4488	DRAINAGE	-
														84	1012	CONSTRUCTION	11/15/99
37	11, 12	PEKING COPE NORTH, INC.	0.548	1.36	0.548	1.36	-	-	0	0	-	-	-	-	-	-	-
38	14, 15	FERNANDEZ, JAMES R.	0.621	1.58	0.015	0.04	0.616	1.52	-	-	-	-	-	208	2238	DRIVE	11/15/99
39	15	FERNANDEZ, B. JEAN	0.684	20.00	4.478	11.08	2.818	6.94	-	-	28	288	DRAINAGE	-	-	-	-

TABLE OF REVISIONS

REV. NO.	DATE	SHEET NO.	DESCRIPTION
1	8/26/98	12	PARCEL 15 - GUARDRAIL EASEMENT DECREASED TO ELIMINATE RAIL ALONG FRONTAGE. CHANNEL EASEMENT DECREASED ELIMINATING NEED TO RELOCATE EXISTING PROPANE TANK.
1	8/26/98	12, 13	PARCELS 17 & 22 - DRIVEWAY REDESIGNED TO PROVIDE A SHARED DRIVE BETWEEN PARCELS.
1	8/26/98	13	PARCELS 22 & 23 - PROPERTY OWNER'S NAME CHANGED TO RED PHOENIX PUB. INC.
1	8/26/98	13	PARCEL 26 - CONSTRUCTION NOTE ADDED TO SAVE TREES BEHIND PROPOSED RETAINING WALL.

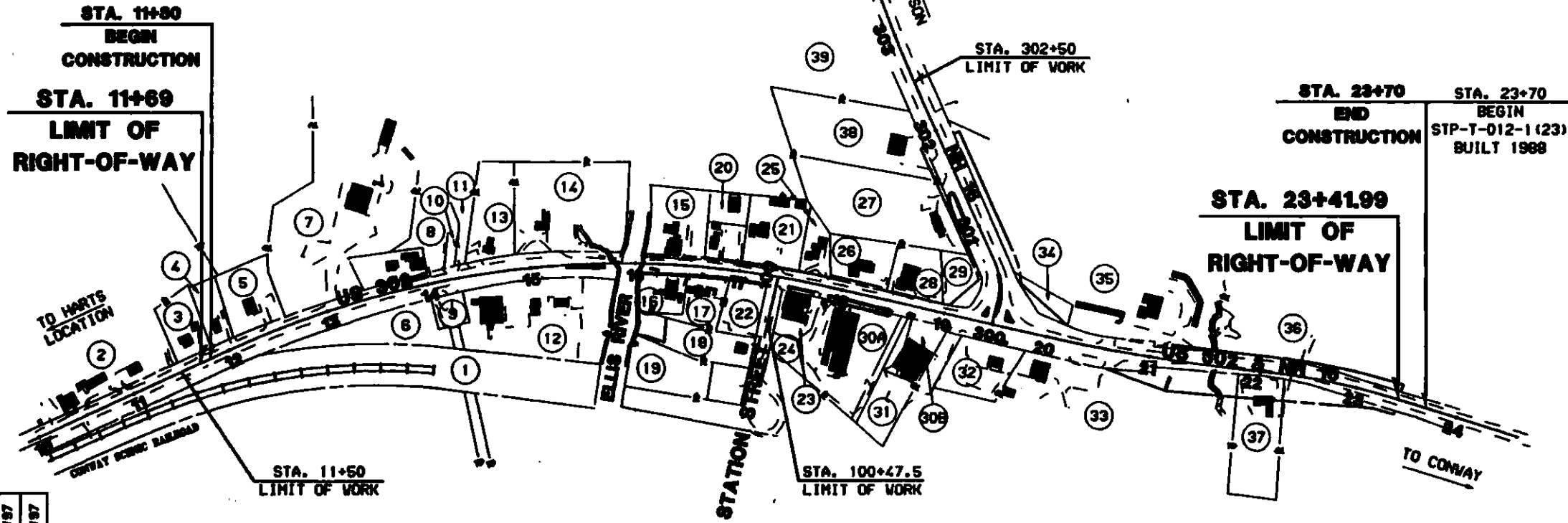
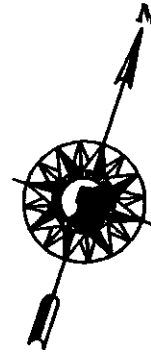

PARCEL NUMBER	PROPERTY OWNER	CROSS POINTS OF ACCESS	
		LT.	RT.
1	MAINE CENTRAL R.R.		
2	THE HOWARD TRUST		
3	HOWARD, GEORGE L., LETITIA G.		
4	SONYA, RICHARD E., BARBARA S.		
5	ROBERTS, LYNN & JUDITH		
6	PATCH, RONALD J.		
7	STATE OF NEW HAMPSHIRE		
8	ROBER, JOHN & DOROTHEA		
9	BOFF, RICHARD J. JR., MURPHY, WILLIAM		
10	THE HOWARD TRUST		
11	HENRIKSON, CLARA L.		
12	PATCH, RONALD J.		
13	CHARLES, LESTER L., ALICE H.		
14	DUSZA, JANE ELLEN		
15	BARANSKI, JANICE E.		
16	TOWN OF BARTLETT		
17	MARK & FERRUOLO PARTNERSHIP		
18	INITOU SKI RUNNERS, INC.		
19	RICHARDS, DAVID J., JOANNE H.		
20	OLEN COMMUNITY BAPTIST CHURCH		
21	GRANT, MARGARET F.		
22	RED PARKA PUB, INC.		
23	RED PARKA PUB, INC.		
24	GRANT, MARGARET		
25	NYSTEDT, EVAN T.		
26	LANSDON, JAMES P., EILEEN H.		
27	THE NORTH CONWAY BANK	2	
28	JANUZZI, FRANK C., GILDA C.		
29	MOUNT WASHINGTON SUMMIT ROAD COMPANY	0	
30A	GRANT DEVELOPMENT CORPORATION		
30B	GRANT DEVELOPMENT CORPORATION		
31	NEW HAMPSHIRE ELECTRIC COOPERATIVE INC.		
32	DOMNE-RUGLES, INC.		
33	FILIP, JAN G., TOFFT, CHARLESS		
34	MOUNT WASHINGTON SUMMIT ROAD COMPANY	0	
35	STORYBOOK MOTOR INN, INC.		1
36	FILIP, JAN G., TOFFT, CHARLESS		
37	PEKING CAFE NORTH, INC.		
38	FERNANDEZ, JEANNE R.	1	
39	FERNANDEZ, S. JEAN		

DATE 11/18/97
 DATE 11/28/97
 DRAWN BY JOHN CHAMBLIN
 CHECKED BY RUTH ROLPH

PROPERTY LAYOUT
 APPROXIMATE SCALE 1 : 2500

NOTE: PLAN SHALL NOT BE CONSTRUED AS A BOUNDARY SURVEY

SAMPLE PLANS
 DATE 31-DEC-1998

METRIC

FEDERAL PROJECT NO.	STATE PROJECT NO.	SHEET NO.	TOTAL SHEETS
	P-4378		

